

REVISIONS				
ZONE	REV	DESCRIPTION	DATE	APPROVED
	A	ORIGINAL DRAWING	15 DEC 08	RRM

SCH 40 OD = 4 1/2" Inches
 Wall Thickness - .237

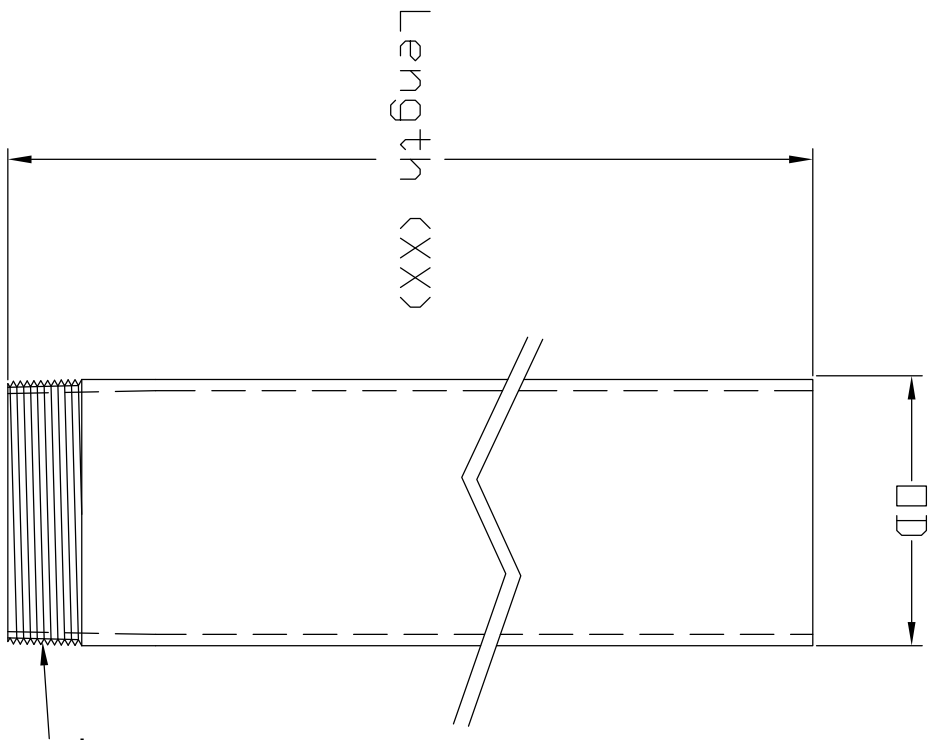

NOTE: Length specified by customer at time of order.

Component Products, Inc. 521 Morse Avenue Schaumburg, IL 60193 Tel (847) 301-1000 Fax (847) 301-0100		CPI-AP-XX-40 Seamless Aluminum Pole SCH 40 -- Threaded One End	
Material Seamless Aluminum Pipe 6061-T6 per ASTM B429		SIZE D	DRAWN BY RRM
SCALE		DWG NO. CPI-AP-XX-40_15 DEC 08	REV D
		SHEET	