

**POLE RATING (PER AASHTO 2013):**  
 3-SEC GUST WIND SPEED: 90 MPH MAX  
 EPA (LUMINAIRE): 1.3 SQ. FT. MAX  
 WEIGHT (LUMINAIRE): 55 LBS MAX

▲ 1" WIDE x 1/4" THK. ALUMINUM GROUND BAR WITH A 3/8"-16 HOLE FOR A GROUND CONNECTOR WELDED OPPOSITE HANDHOLE

▲ 4" x 8" REINFORCED ALUMINUM HANDHOLE OPENING & FLUSH FITTING ALUMINUM DOOR ATTACHED WITH (2) 1/4"-20 x 3/4" LG. NYLON HEX HEAD BOLTS AND BRASS HANDHOLE KEEPER CHAIN 12" LG. AND FASTENED TO CENTER OF HANDHOLE COVER & INSIDE BOTTOM OF HANDHOLE

**NOTE:**  
 3 7/16" x 6 3/32" MIN. DEBURRED CLEAR OPENING

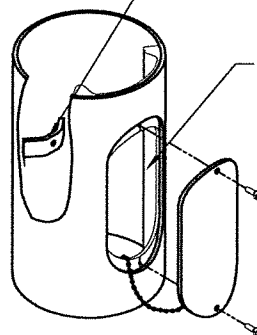

**HANDHOLE DETAIL**

TYPE OP302-12

DO NOT SCALE



Valmont Industries, Inc. Structures Division  
 20805 Eaton Ave Farmington, Minnesota 55024-7932  
 Phone: (651) 463-8990 (800) 899-7577  
 Fax: (651) 463-3349

TITLE: TRANSFORMER BASE ALUMINUM POLE		QTY:
MODEL NO.: 260860806T4A		OWN BY: PVB
MATERIAL: ALUMINUM ALLOY		CHK'D BY:
FINISH: 100 GRIT SATIN POLISH		APPR BY: Mps
PROJECT: CITY OF OVERLAND PARK, KS		DATE: 09-22-17
SOLD TO: CITY OF OVERLAND PARK, KS		DWG NO: DSOP
SHIP TO:		PAGE:
P.O. NO:		BY: KPS
REP: POWER EQUIPMENT SALES		3 / 18
▲		
▲	04/06/18	UPDATED NOTES & J-HOOK SIZE
▲		

**\*\*CONFIDENTIAL\*\***

The information contained in this drawing is privileged and confidential, and may be protected from disclosure. Please be aware that any use or dissemination of this drawing may be subject to legal restriction or sanction.