

~~Medium Duty Frame & Cover:~~
~~Clay & Bailey No. 2020~~
~~Deeter No. 2016~~
~~East Jordan Iron Works No. 1501~~
~~or Approved Equal~~

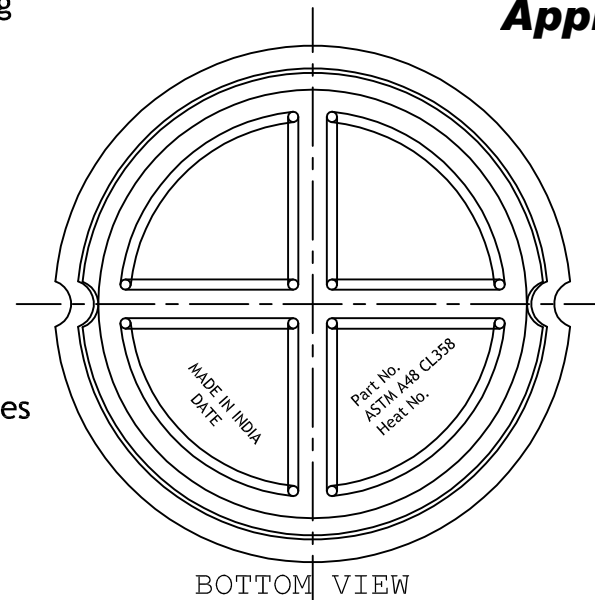

Approved as Noted

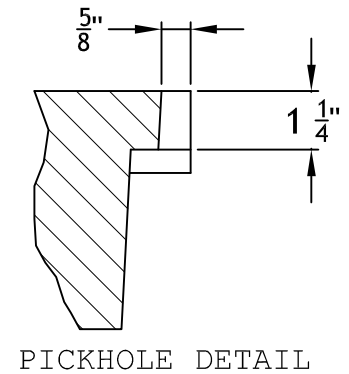

MANHOLE CASTING NOTES :

1. Casting shall comply with ASTM A-48 and AASHTO M306-04
2. As-cast dimension may vary $\pm \frac{1}{16}$ Inch per foot.
3. Each casting shall be marked in accordance with AASHTO M 306-04. Sec.9.
4. A full scale drawing of the Overland Park City Logo shall be obtained through the City.
5. The letters "OP" on the Logo shall be raised relative to the tree. The tree surface shall be irregular.
6. Raised surfaces shall be cast as non-skid finish.
7. The surfaces labeled on these details as ∇ shall be machined.
8. For private systems omit Overland Park Logo and lettering.
9. Paint is optional unless specified.

01	Weight & Note are changed as per the drawing.	24.03.06	
REV	ALTERATION	EFFECTIVE	SIGN/DATE
MATERIAL: C.I -ASTM 48 CL-40			
TITLE: MANHOLE COVER		CKD, Drawn	Date
		MNV, SHANMUKH	22.03.06
DRG.NO: SMC 2100 OP SHEET 02 OF 04		USER	UNITS
		C	INCHES
		SCALE	NTS
GCI CASTINGS INC.			
P.O.BOX.NO.4125, BONNER INDL. DRIVE, SHAWNEE MISSION, KANSAS 66226, USA.			

WEIGHT :
 Cover 134 lbs (± 6.75 lbs.)

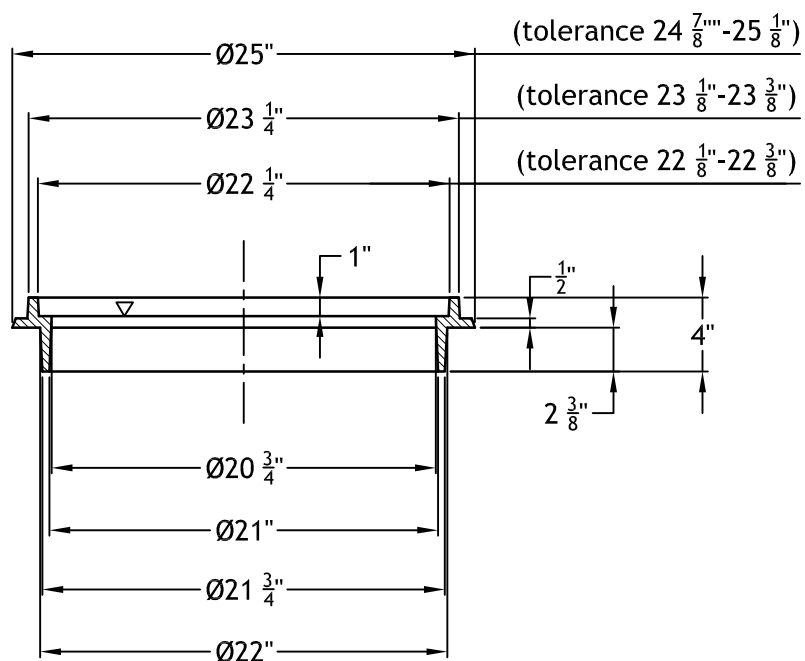
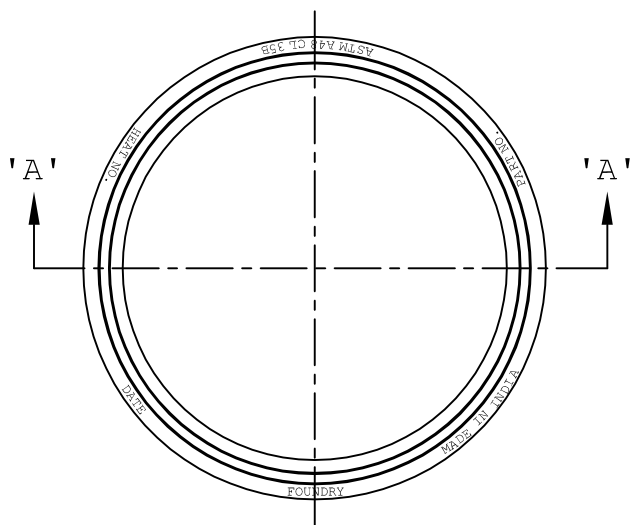

SECTION AT A-A

MANHOLE CASTING NOTES :

1. Casting shall comply with ASTM A-48 and AASHTO M306-04
2. As-cast dimension may vary $\pm \frac{1}{16}$ Inch per foot.
3. Each casting shall be marked in accordance with AASHTO M 306-04. Sec.9.
4. A full scale drawing of the Overland Park City Logo shall be obtained through the City.
5. The letters "OP" on the Logo shall be raised relative to the tree. The tree surface shall be irregular.
6. Raised surfaces shall be cast as non-skid finish.
7. The surfaces labeled on these details as ∇ shall be machined.
8. For private systems omit Overland Park Logo and lettering.
9. Paint is optional unless specified.

~~Heavy Duty Frame & Cover :~~

~~Clay & Bailey No. 2007MR~~

~~Deeter No. 1320~~

~~East Jordan Iron Works No. 1502~~

~~or Approved Equal~~

01	Weight is changed as per the drawing.	24.03.06	
REV	ALTERATION	EFFECTIVE	SIGN/DATE
MATERIAL: C.I -ASTM 48 CL-40			
TITLE: RISER RING		CKD, Drawn	Date
		MNV SHANMUKH	22.03.06
DRG.NO: SM 2100 OP SHEET 03 OF 04		USER	UNITS
			INCHES
		C	SCALE
GCI CASTINGS INC.		REV.	NTS
P.O.BOX.NO.4125, BONNER INDL. DRIVE, SHAWNEE MISSION, KANSAS 66226, USA.			

WEIGHT :
52 lbs (±2.5 lbs.)