

# DURALAST Detectable Warning Plate

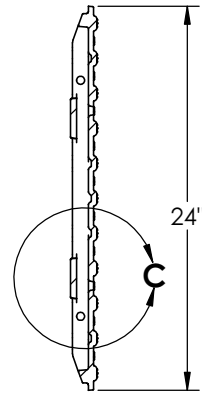

**SECTION B-B**

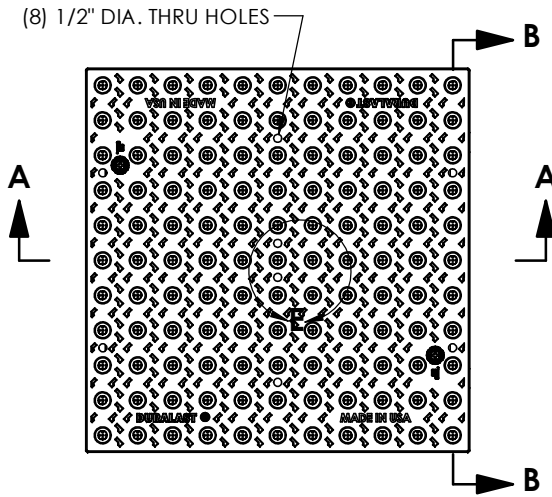
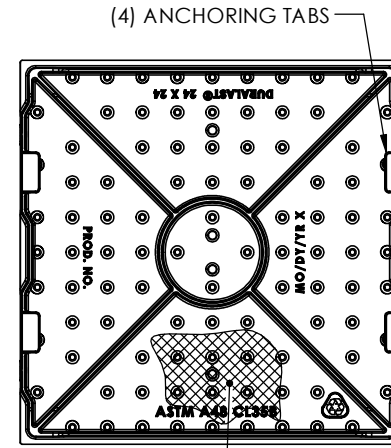

**BOTTOM VIEW**

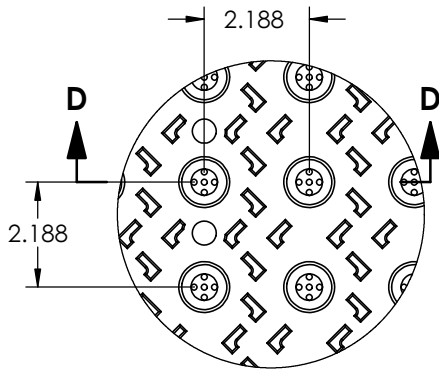

**DETAIL E**

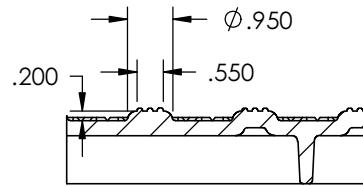

**SECTION D-D  
SCALE 1 : 4**

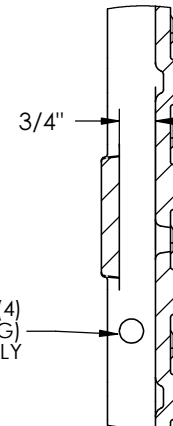

**DETAIL C**

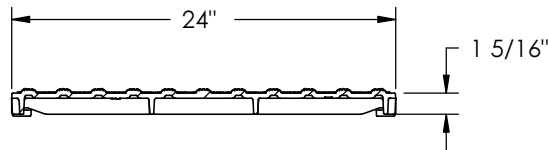

**SECTION A-A**

1/2" DIA. HOLES (4)  
PLACES (FOR BOLTING)  
HAND TIGHTEN ONLY

**Product Number**

00700571

**Design Features**

- Materials  
Gray Iron (CL35B)
- Design Load  
Heavy Duty
- Open Area  
n/a
- Coating  
Undipped
- √ Designates Machined Surface

**Certification**

- ASTM A48
- ADAAG
- Country of Origin: USA

**Estimated Weight**

65.00 lbs.

**Drawing Revision**

11/23/2009 Designer: JIJ  
8/19/2015 Revised By: MAH

**Disclaimer**

Weights (lbs/kg), dimensions (inches/mm) and drawings provided for your guidance. We reserve the right to modify specifications without prior notice.

CONFIDENTIAL: This drawing is the property of EJ Group, Inc. and embodies confidential information, registered marks, patents, trade secret information, and/or know how that is the property of EJ Group, Inc. Copyright © 2011 EJ Group, Inc. All rights reserved.

**Contact**

800 626 4653  
ejco.com

# DURALAST Detectable Warning Plate

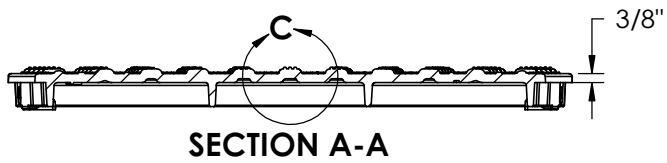
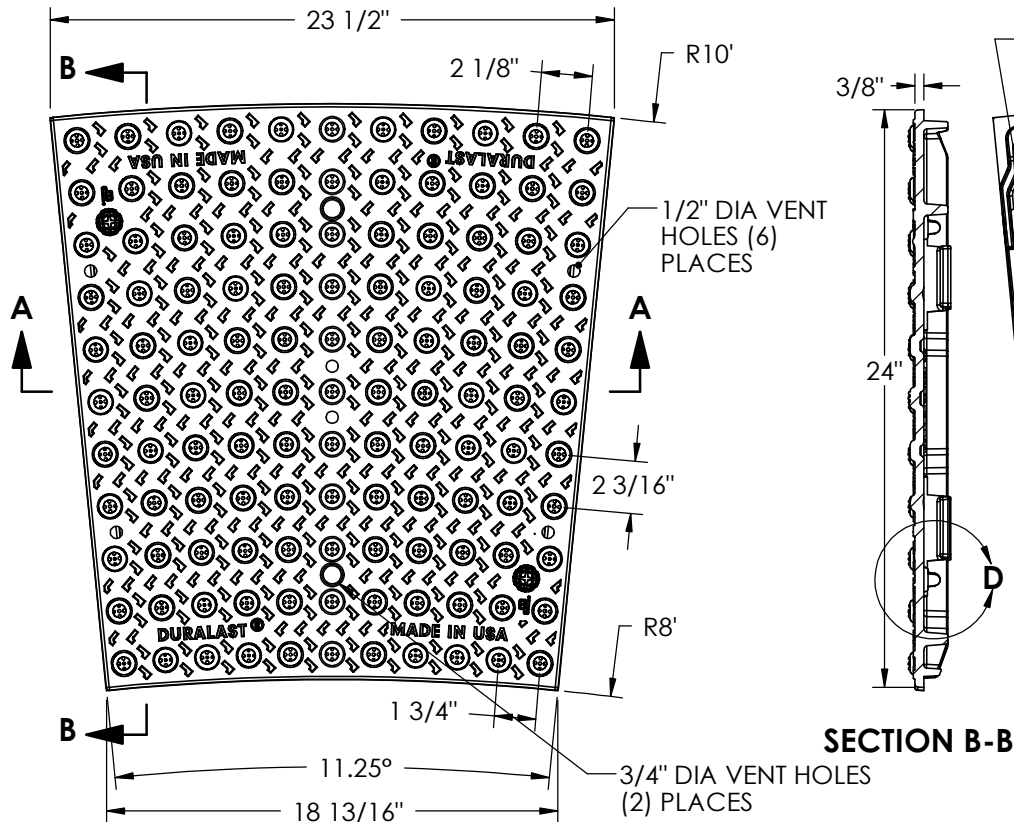

SECTION A-A

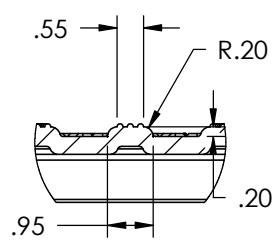

DETAIL C  
SCALE 1 : 4

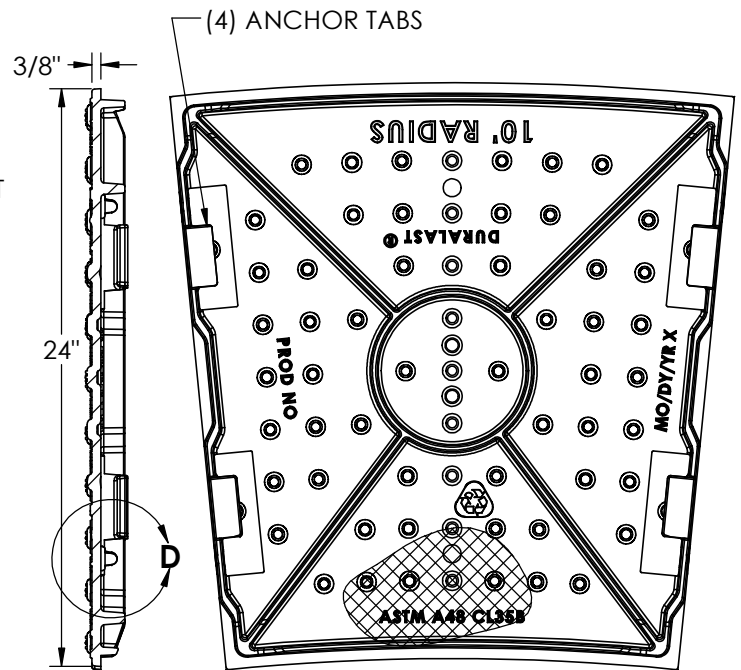

BOTTOM VIEW

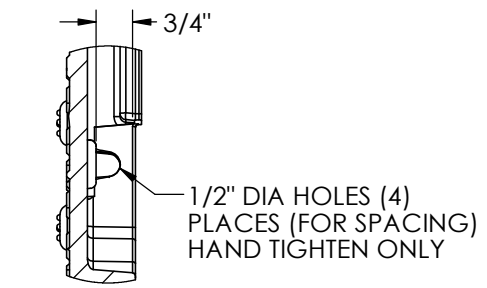

DETAIL D  
SCALE 1 : 4

**Product Number**  
00700611

**Design Features**

- Materials  
Gray Iron (CL35B)
- Design Load  
Heavy Duty
- Open Area  
n/a
- Coating  
Undipped
- √ Designates Machined Surface
- Slip Resistant Surface  
with the LLLL® registered trademark

**Certification**

- ASTM A48
- ADAAG
- Country of Origin: USA

**Drawing Revision**

- 2/2/2010 Designer: DEW
- 8/19/2015 Revised By: MAH

**Disclaimer**

Weights (lbs/kg), dimensions (inches/mm) and drawings provided for your guidance. We reserve the right to modify specifications without prior notice.

CONFIDENTIAL: This drawing is the property of EJ Group, Inc. and embodies confidential information, registered marks, patents, trade secret information, and/or know how that is the property of EJ Group, Inc. Copyright © 2011 EJ Group, Inc. All rights reserved.

**Contact**

800 626 4653  
ejco.com

# DURALAST Detectable Warning Plate

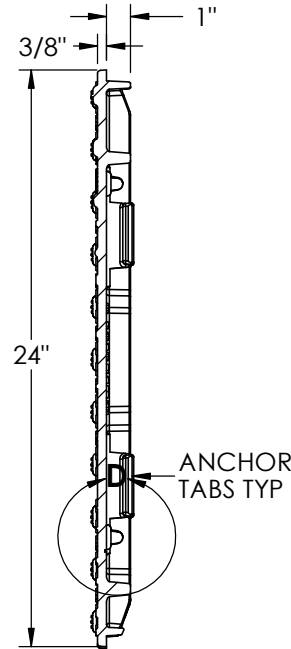
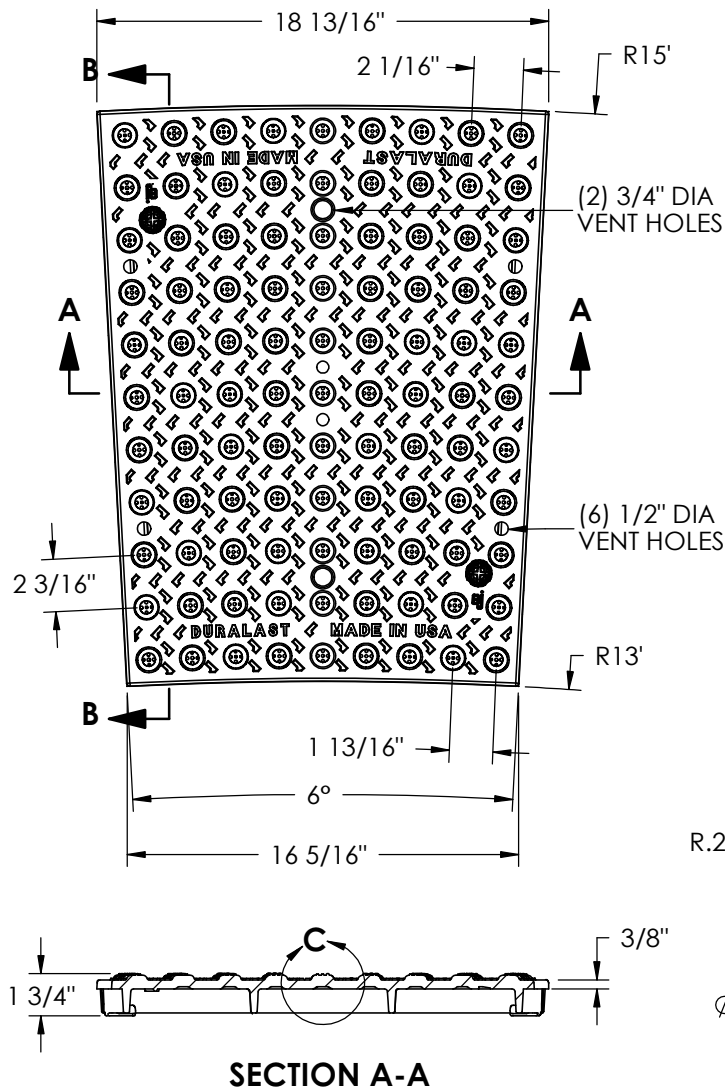

SECTION B-B

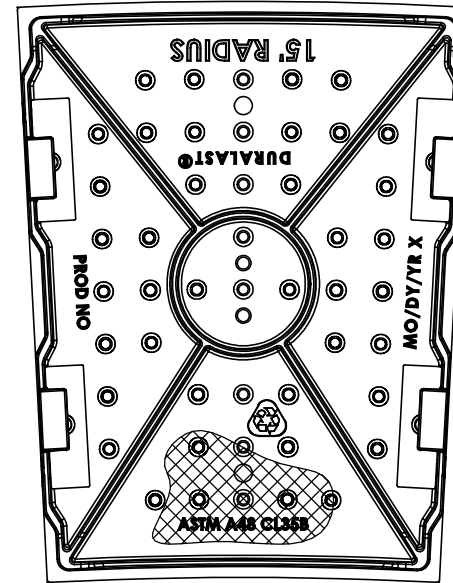
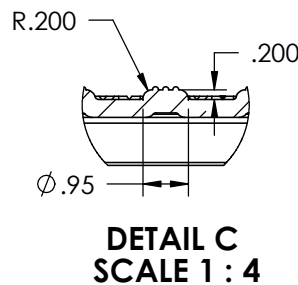

BOTTOM VIEW

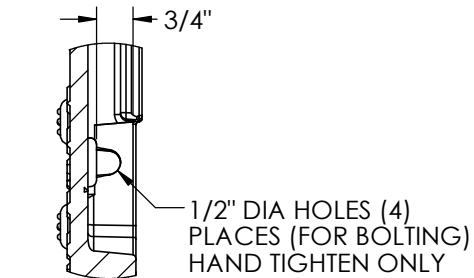

**Product Number**

00700615

**Design Features**

- Materials  
Gray Iron (CL35B)
- Design Load  
Heavy Duty
- Open Area  
n/a
- Coating  
Undipped
- √ Designates Machined Surface
- Slip Resistant Surface  
with the LLLL® registered trademark

**Certification**

- ASTM A48
- 
- Country of Origin: USA

**Drawing Revision**

2/2/2010 Designer: DEW  
7/21/2015 Revised By: LCK

**Disclaimer**

Weights (lbs/kg), dimensions (inches/mm) and drawings provided for your guidance. We reserve the right to modify specifications without prior notice.

CONFIDENTIAL: This drawing is the property of EJ Group, Inc. and embodies confidential information, registered marks, patents, trade secret information, and/or know how that is the property of EJ Group, Inc. Copyright © 2011 EJ Group, Inc. All rights reserved.

**Contact**

800 626 4653  
ejco.com

# DURALAST Detectable Warning Plate

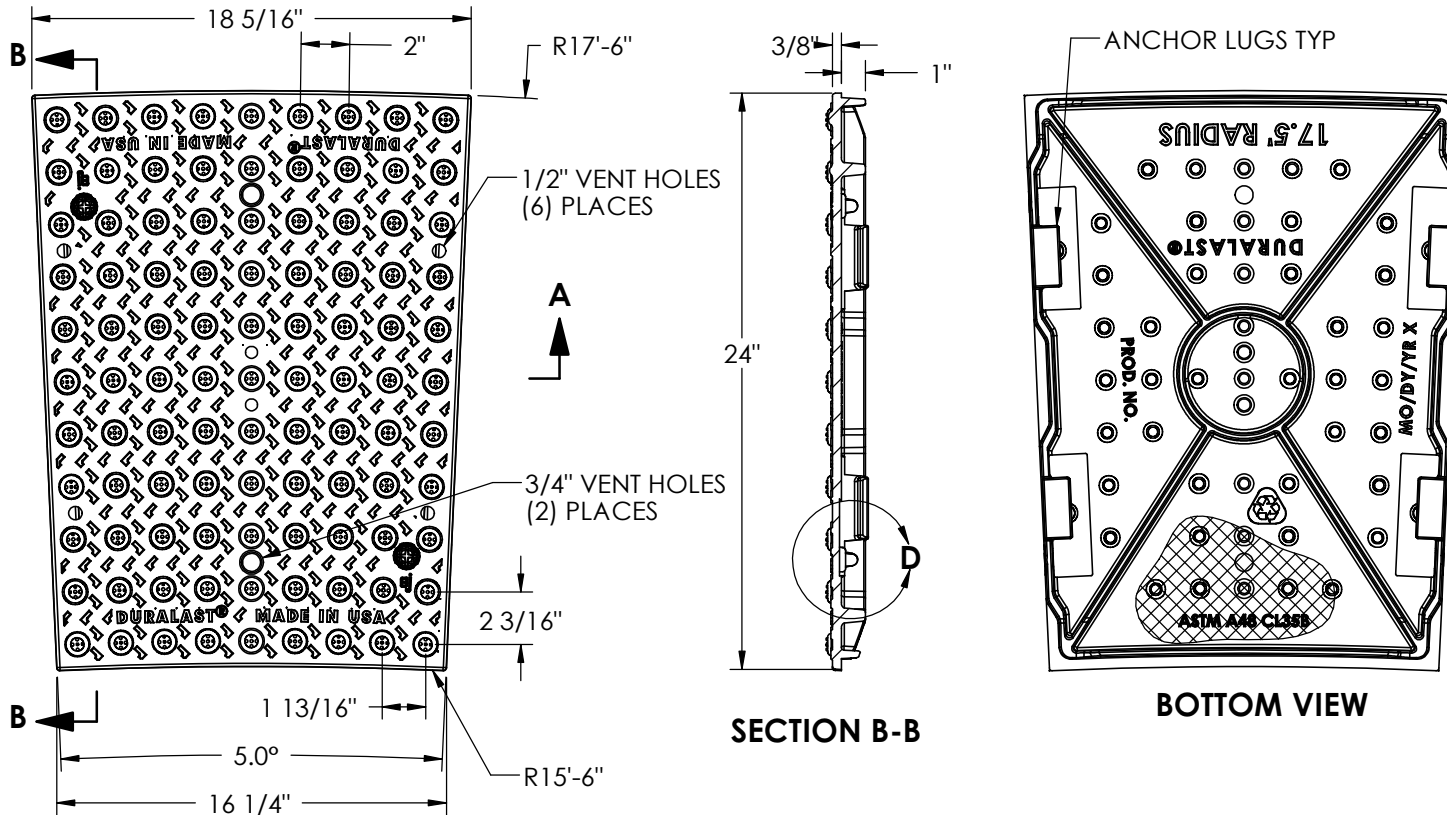

A ↑

A ↑

B ←

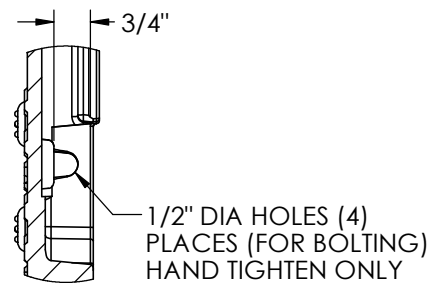
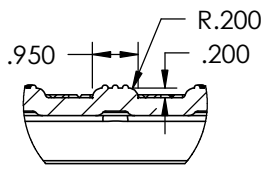
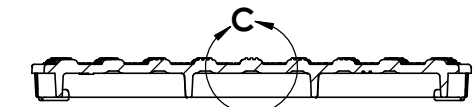

## Product Number

00700618

## Design Features

- Materials  
Gray Iron (CL35B)
- Design Load  
Heavy Duty
- Open Area  
n/a
- Coating  
Dipped
- √ Designates Machined Surface
- Slip Resistant Surface  
with the LLLL® registered trademark

## Certification

- ASTM A48
- 
- Country of Origin: USA

## Drawing Revision

2/2/2010 Designer: DEW  
7/21/2015 Revised By: LCK

## Disclaimer

Weights (lbs/kg), dimensions (inches/mm) and drawings provided for your guidance. We reserve the right to modify specifications without prior notice.

CONFIDENTIAL: This drawing is the property of EJ Group, Inc. and embodies confidential information, registered marks, patents, trade secret information, and/or know how that is the property of EJ Group, Inc. Copyright © 2011 EJ Group, Inc. All rights reserved.

## Contact

800 626 4653  
ejco.com

# DURALAST Detectable Warning Plate

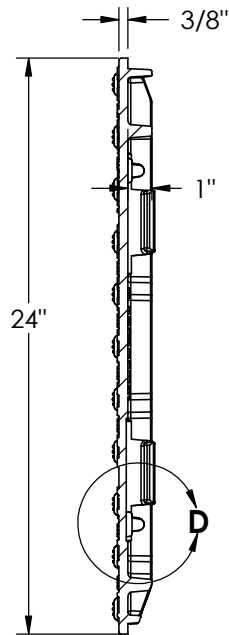
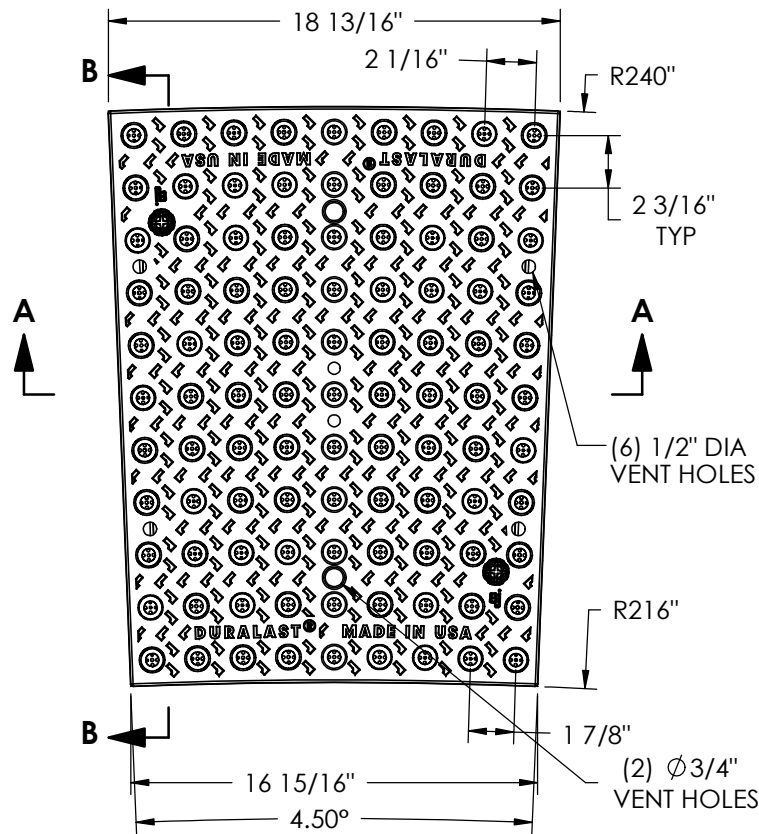

SECTION B-B

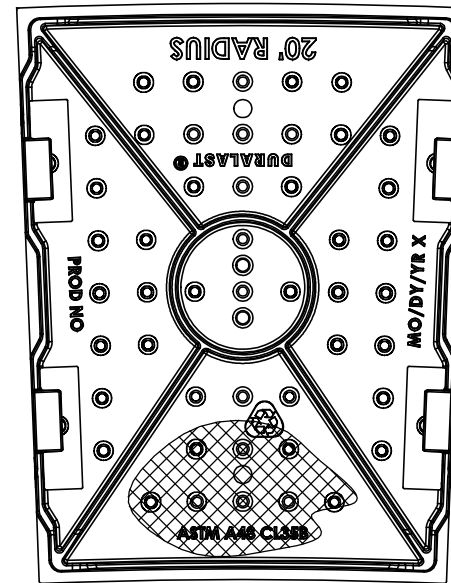

BOTTOM VIEW

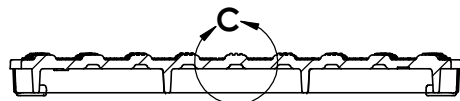

SECTION A-A

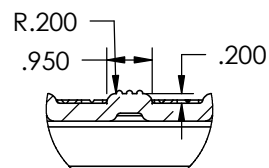

DETAIL C  
SCALE 1 : 4

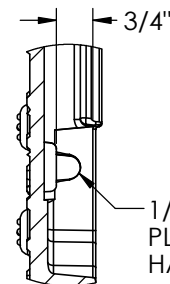

DETAIL D  
SCALE 1 : 4

## Product Number

00700620

## Design Features

- Materials  
Gray Iron (CL35B)
- Design Load  
Heavy Duty
- Open Area  
n/a
- Coating  
Dipped
- √ Designates Machined Surface
- Slip Resistant Surface  
with the LLLL® registered trademark

## Certification

- ASTM A48
- 
- Country of Origin: USA

## Drawing Revision

2/2/2010 Designer: DEW  
7/21/2015 Revised By: LCK

## Disclaimer

Weights (lbs/kg), dimensions (inches/mm) and drawings provided for your guidance. We reserve the right to modify specifications without prior notice.

CONFIDENTIAL: This drawing is the property of EJ Group, Inc. and embodies confidential information, registered marks, patents, trade secret information, and/or know how that is the property of EJ Group, Inc. Copyright © 2011 EJ Group, Inc. All rights reserved.

## Contact

800 626 4653  
ejco.com

# DURALAST Detectable Warning Plate

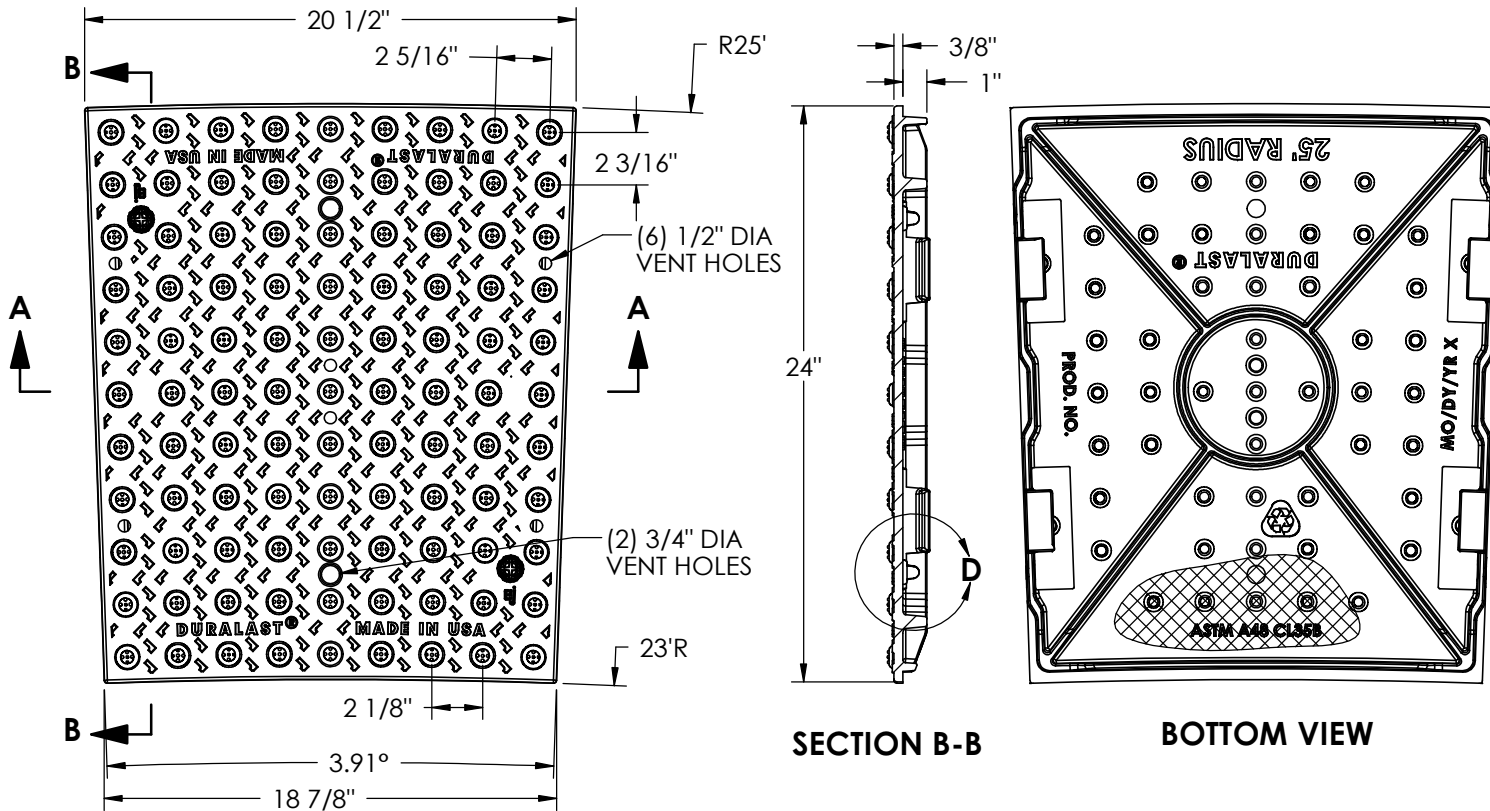

SECTION B-B

BOTTOM VIEW

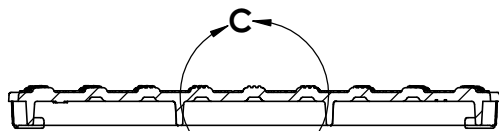

SECTION A-A

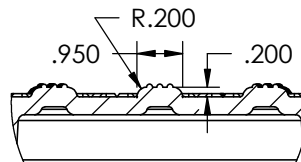

DETAIL C  
SCALE 1 : 4

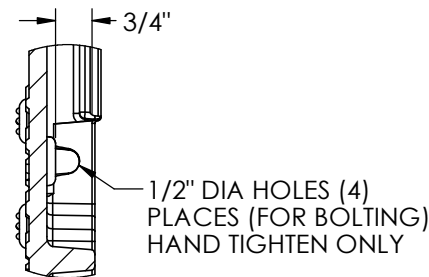

DETAIL D  
SCALE 1 : 4

**Product Number**

00700626

**Design Features**

- Materials  
Gray Iron (CL35B)
- Design Load  
Heavy Duty
- Open Area  
n/a
- Coating  
Dipped
- √ Designates Machined Surface
- Slip Resistant Surface  
with the LLLL® registered trademark

**Certification**

- ASTM A48
- 
- Country of Origin: USA

**Drawing Revision**

- 2/3/2010 Designer: DEW
- 7/21/2015 Revised By: LCK

**Disclaimer**

Weights (lbs/kg), dimensions (inches/mm) and drawings provided for your guidance. We reserve the right to modify specifications without prior notice.

CONFIDENTIAL: This drawing is the property of EJ Group, Inc. and embodies confidential information, registered marks, patents, trade secret information, and/or know how that is the property of EJ Group, Inc. Copyright © 2011 EJ Group, Inc. All rights reserved.

**Contact**

800 626 4653  
ejco.com

# DURALAST Detectable Warning Plate

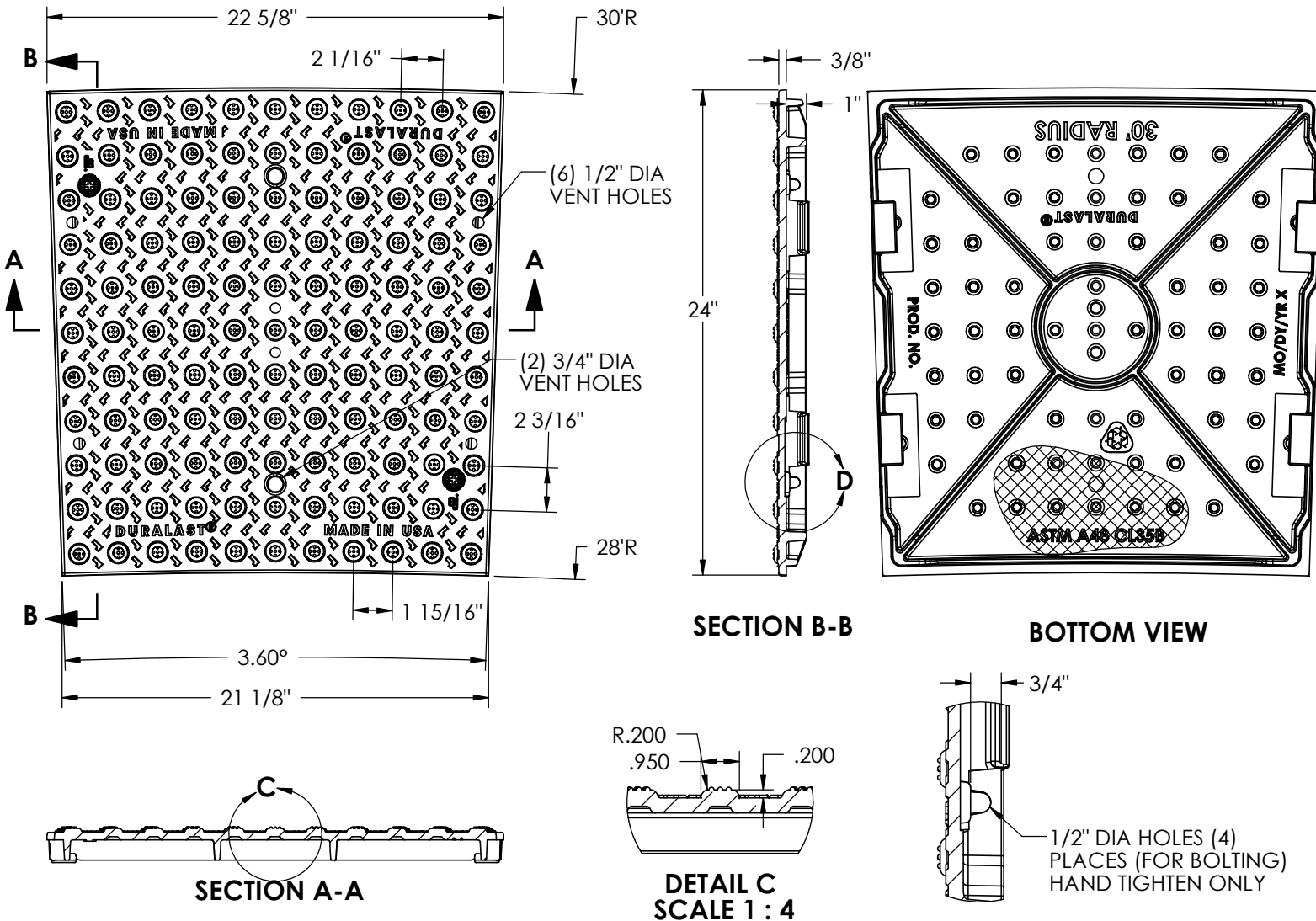

## Product Number

00700630

## Design Features

- Materials  
Gray Iron (CL35B)
- Design Load  
Heavy Duty
- Open Area  
n/a
- Coating  
Dipped
- √ Designates Machined Surface
- Slip Resistant Surface  
with the LLLL® registered trademark

## Certification

- ASTM A48
- 
- Country of Origin: USA

## Drawing Revision

2/3/2010 Designer: DEW  
 7/21/2015 Revised By: LCK

## Disclaimer

Weights (lbs/kg), dimensions (inches/mm) and drawings provided for your guidance. We reserve the right to modify specifications without prior notice.

CONFIDENTIAL: This drawing is the property of EJ Group, Inc. and embodies confidential information, registered marks, patents, trade secret information, and/or know how that is the property of EJ Group, Inc. Copyright © 2011 EJ Group, Inc. All rights reserved.

## Contact

800 626 4653  
 ejco.com

# DURALAST Detectable Warning Plate

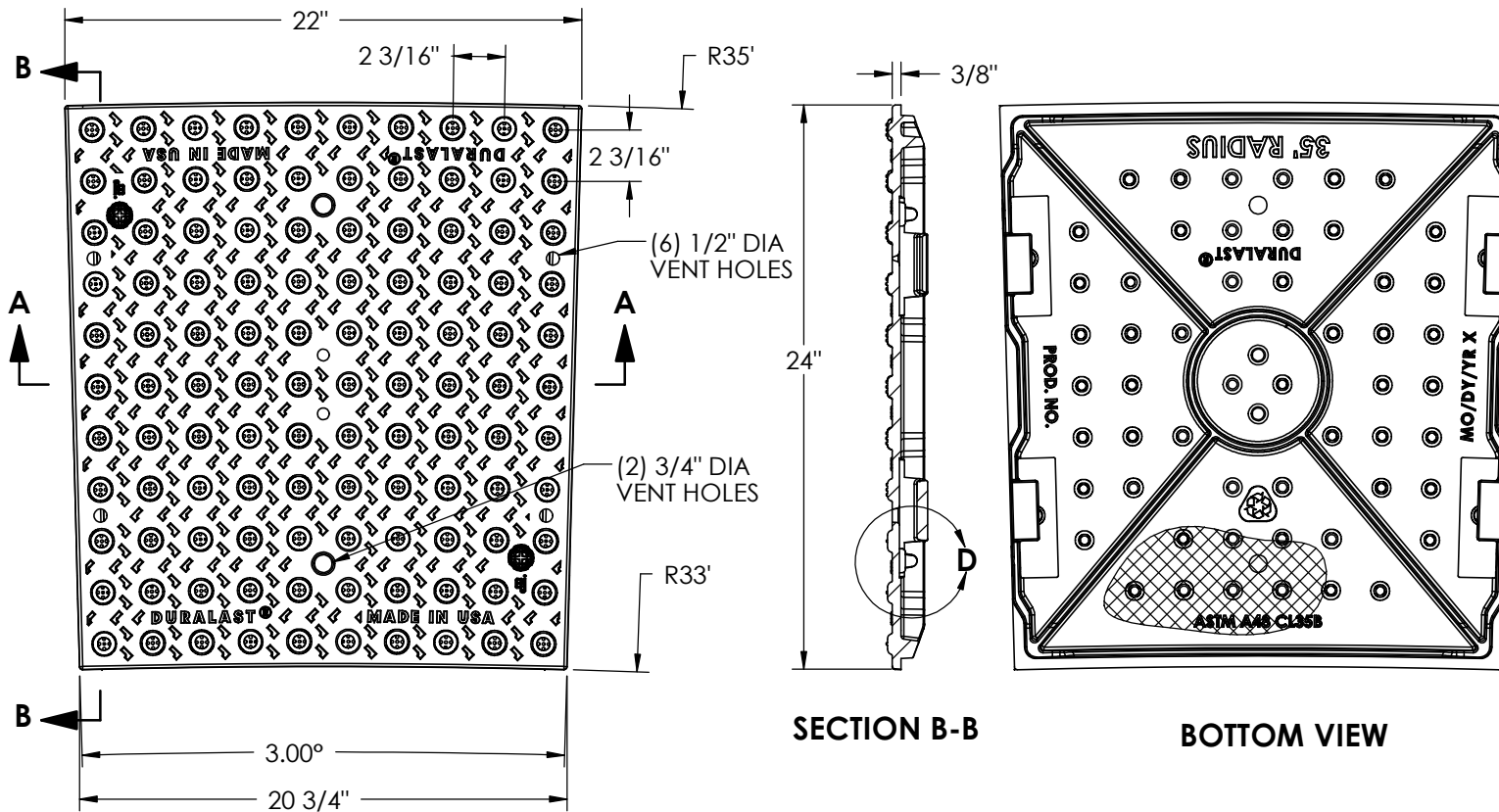

## Product Number

00700636

## Design Features

- Materials  
Gray Iron (CL35B)
- Design Load  
Heavy Duty
- Open Area  
n/a
- Coating  
Dipped
- √ Designates Machined Surface
- Slip Resistant Surface  
with the LLLL® registered trademark

## Certification

- ASTM A48
- 
- 
- Country of Origin: USA

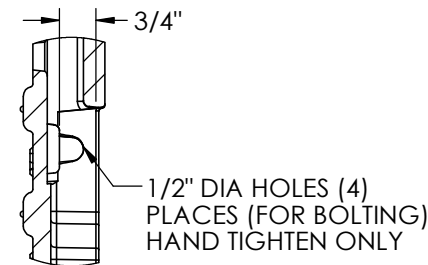
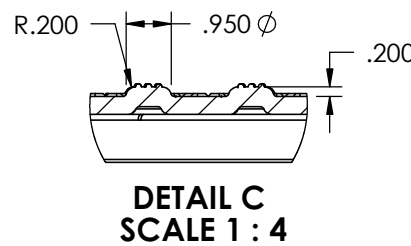
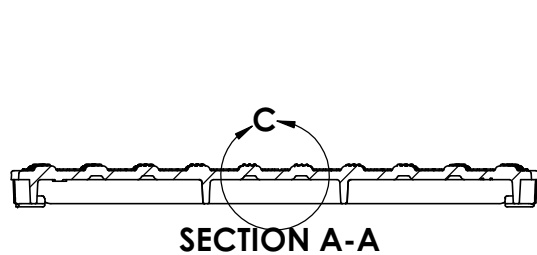

## Drawing Revision

2/3/2010 Designer: DEW  
7/20/2015 Revised By: LCK

## Disclaimer

Weights (lbs/kg), dimensions (inches/mm) and drawings provided for your guidance. We reserve the right to modify specifications without prior notice.

CONFIDENTIAL: This drawing is the property of EJ Group, Inc. and embodies confidential information, registered marks, patents, trade secret information, and/or know how that is the property of EJ Group, Inc. Copyright © 2011 EJ Group, Inc. All rights reserved.

## Contact

800 626 4653  
ejco.com